



53226 Thrust ball bearings, single direction

- Popular item

Thrust ball bearings, single direction

Bearing data

[Tolerances,](#)
table 1

Bearing interfaces

[Seat tolerances for standard](#)
[conditions,](#)
[Tolerances and resultant fit](#)

Technical specification

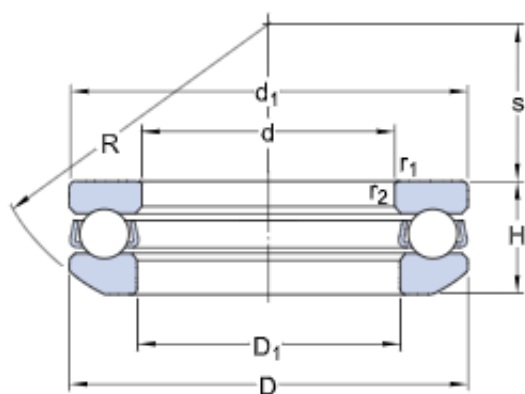

DIMENSIONS

d	130 mm	Bore diameter
D	190 mm	Outside diameter
H	47.9 mm	Height
H ₁	53 mm	Height bearing including seat washer
d ₁	≈ 187 mm	Outside diameter shaft washer
D ₁	≈ 133 mm	Inner diameter housing washer
D ₂	160 mm	Inner diameter sphered seat washer
D ₃	195 mm	Outside diameter sphered housing washer
C	17 mm	Height sphered housing washer
R	140 mm	Radius sphered housing washer
s	67 mm	Centre height housing washer sphere
r _{1,2}	min. 1.5 mm	Chamfer dimension washer

ABUTMENT DIMENSIONS

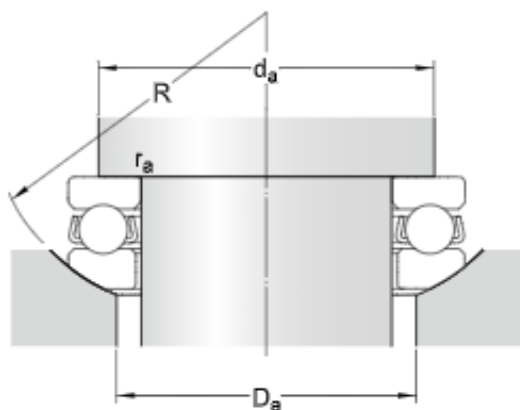

d_a min. 166 mm Abutment diameter shaft

D_a max. 160 mm Abutment diameter housing

r_a max. 1 mm Fillet radius



CALCULATION DATA

C	186 kN	Basic dynamic load rating
C_0	585 kN	Basic static load rating
P_u	17 kN	Fatigue load limit
	1 300 r/min	Reference speed
	1 800 r/min	Limiting speed
A	1.8	Minimum load factor

MASS

4.85 kg	Mass bearing (including seat washer where applicable)
---------	---

ASSOCIATED PRODUCTS